

Spitfire Bonnet Lift Kit Installation Instructions

Thank you for purchasing our Kit! It is designed to fit 1962-1970 model years (Mk1-Mk3).

This Kit contains:

- | | |
|---------------|------------------------|
| 2 Gas Springs | 4 Lock Washers |
| 1 LH Bracket | 4 Flat Washers |
| 1 RH Bracket | 4 Nuts |
| 4 Ball Studs | 2 Clipped Flat Washers |

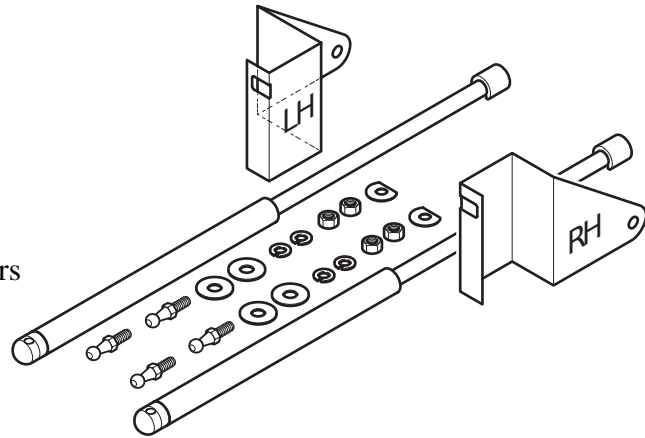

1. Attach a Ball Stud to the RH Bracket as shown.
2. Open your bonnet and set the factory prop.
3. Remove the bolt (and washers and nut) shown in the illustration on page 2.
4. Press in the RH bracket and fasten it, using the same hardware removed in 3 EXCEPT: use the clipped washer against the bolt head as shown. Tighten **securely**, making sure the bracket is fully seated in the channel.

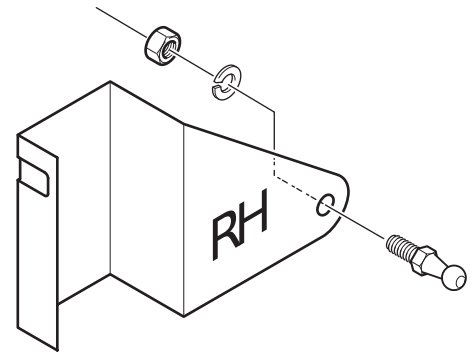

Step 1

5. Place a large washer on a Ball Stud and install it in the proper hole (see illustration). You should be able to turn the Ball Stud and thread it all the way flush without drilling the hole larger. Now apply one more Large Washer and a Lock Washer and fasten tightly with a Nut.
6. Twist the Gas Spring such that the end-fittings are facing opposite directions. The "tube end" of the Gas Spring should be oriented "up" so as to keep the seals lubricated for long life. Press the Gas Spring onto the top Ball Stud, and then by lifting the bonnet slightly, you can press the bottom end of the Gas Spring onto the lower Ball Stud.



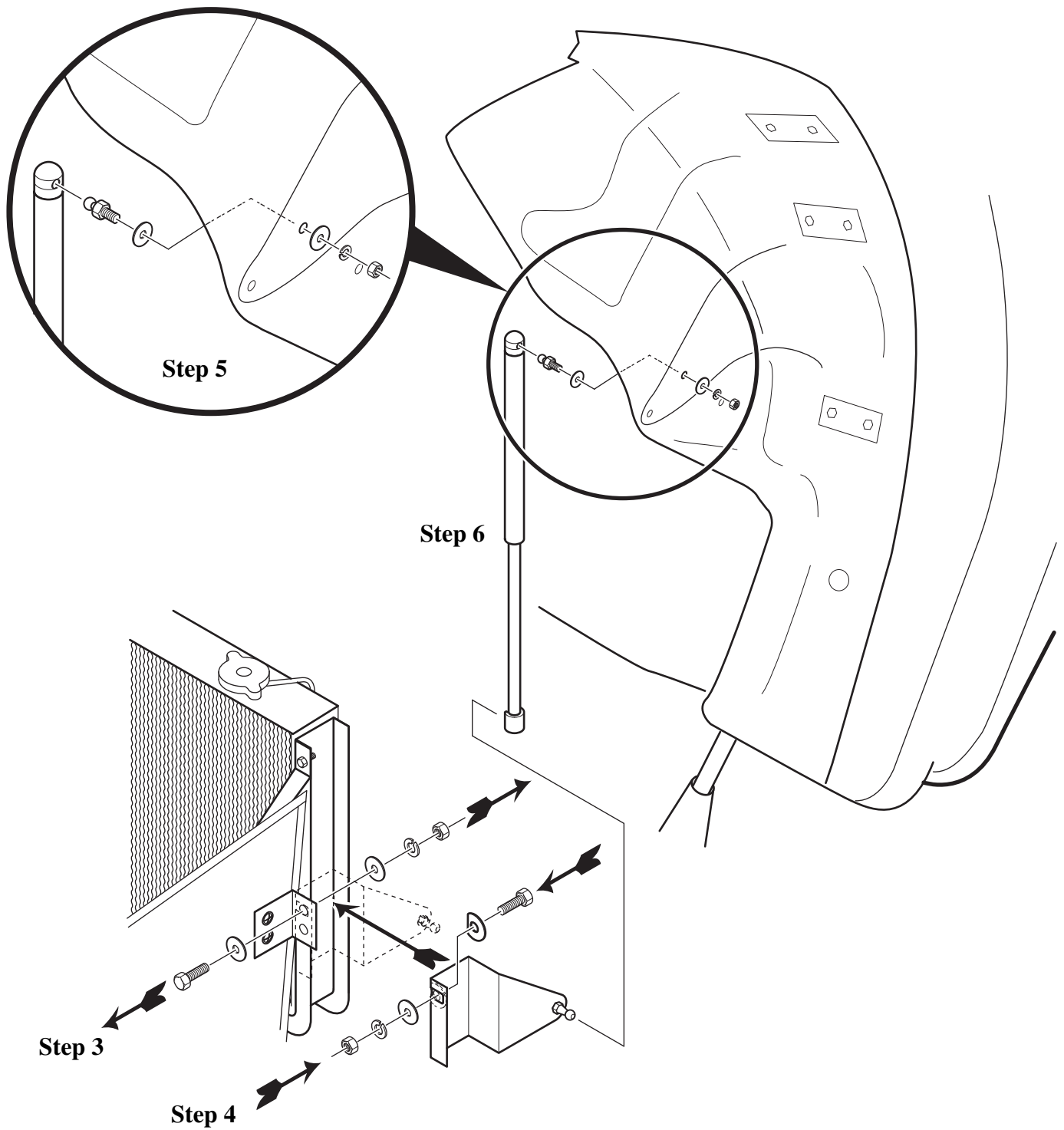

7. Now remove the Factory Prop, and repeat the above steps to install the left hand side.

8. Carefully pull the bonnet down and don't allow it to slam shut.

